

REV.	SPECIFICATION	ECN NO.	APPD.

Material:
Housing: PA6T or LCP, UL94V-0.
Contacts: Brass, Gold Plated on Contact Area and Gold Flash on Solder Tail over Nickel 60u".

Electrical Characteristics:
Current Rating: 1 AMP.
Dielectric Withstanding Voltage: AC 500V.
Insulation Resistance: 1000MΩ min..
Contact Resistance: 20mΩ max.
Operating Temperature: -40°C~+105°C.
***RoHS Compliant**

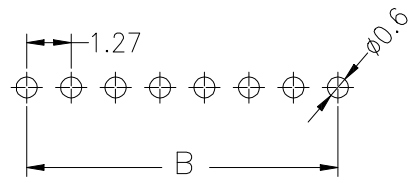
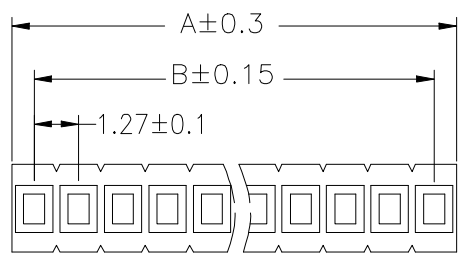

Recommended P.C.B Layout
(PCB BOARD TOLERANCE±0.05)

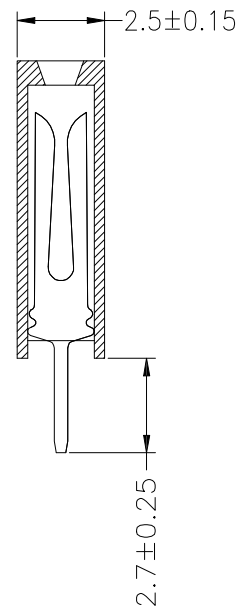
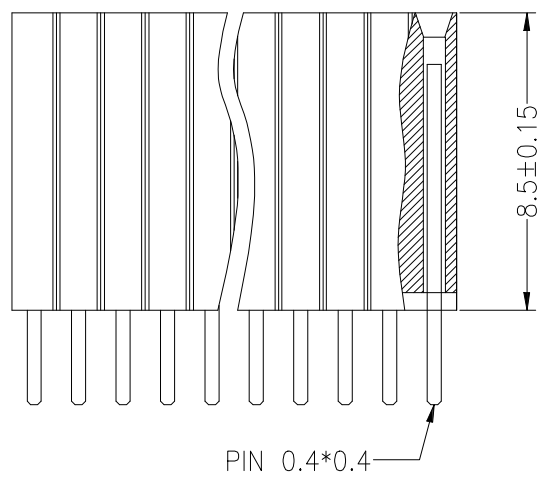

2246-A 1 X xx G xx S U -LCP

Series: 2246-A
Single Row: 1
No. of Position: X xx
G: Gold Plated
00: Gold Flash
03: 03u"
05: 05u"

S: Straight
U: Tube Package for 1X06~1X40Pin
Blank: PA6T
LCP: LCP
B: Bulk Package for 1X01~1X05Pin

Dimension					
Positions	A	B	Positions	A	B
01	1.27	0.00	21	26.67	25.40
02	2.54	1.27	22	27.94	26.67
03	3.81	2.54	23	29.21	27.94
04	5.08	3.81	24	30.48	29.21
05	6.35	5.08	25	31.75	30.48
06	7.62	6.35	26	33.02	31.75
07	8.89	7.62	27	34.29	33.02
08	10.16	8.89	28	35.56	34.29
09	11.43	10.16	29	36.83	35.56
10	12.70	11.43	30	38.10	36.83
11	13.97	12.70	31	39.37	38.10
12	15.24	13.97	32	40.64	39.37
13	16.51	15.24	33	41.91	40.64
14	17.78	16.51	34	43.18	41.91
15	19.05	17.78	35	44.45	43.18
16	20.32	19.05	36	45.72	44.45
17	21.59	20.32	37	46.99	45.72
18	22.86	21.59	38	48.26	46.99
19	24.13	22.86	39	49.53	48.26
20	25.40	24.13	40	50.80	49.53

Tolerances	Dwg No.	2246D02003		Title:	
.x = ±0.30	Projection	⊕ ↗		2246-A Series	
.xx = ±0.20	Unit	mm	Scale	P.C.B Socket 1.27mm	
.xxx = ±0.10	Drawn By	Martin 04/24'24		① 676	

OUPIN
OUPIN ELECTRONIC(KUNSHAN) CO., LTD.
P/N: 2246-A1XxxGxxSU-LCP

SHEET	1/1	Ver.No.	A4
-------	-----	---------	----