

REV.	SPECIFICATION	ECN NO.	APPD.
R1		ECN231013	

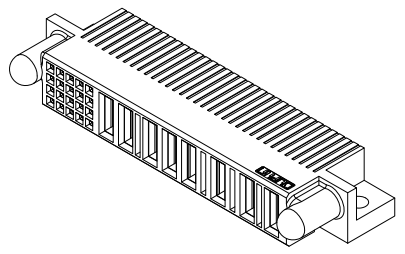

Material and Plating:
Housing: LCP, UL94V-0, BLACK.
Power Contacts: High Conductivity Copper.
 Gold Plated on Contact Area and 80u" Min Tin Plated on Solder Tail over Nickel 50u" Min.
Signal Contacts: Phosphor Bronze.
 Gold Plated on Contact Area and 80u" Min Tin Plated on Solder Tail over Nickel 50u" Min.

Electrical Characteristics:
Current Rating: Signal Pin 2.5 AMP.
 Power Pin 30 AMP.
Dielectric Withstanding Voltage:
 Signal Pin DC 1000V For 1 minute.
 Power Pin DC 2500V For 1 minute.
Insulator Resistance: Signal Pin 5000MΩ min. at DC 500V.
 Power Pin 20000MΩ min. at DC 500V.
Contact Resistance: Signal Pin 15mΩ max. at DC 20mA.
 Power Pin 0.7mΩ max. at DC 20mA.
Operating Temperature: -40°C ~+105°C.

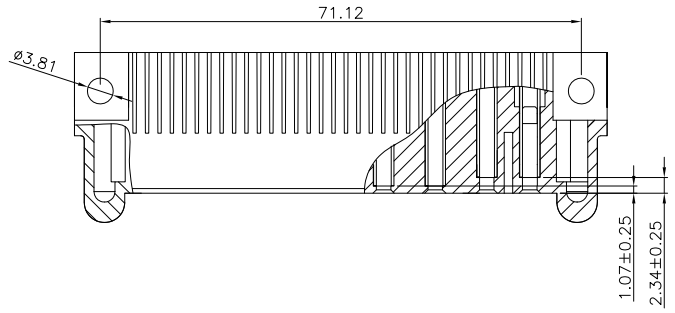
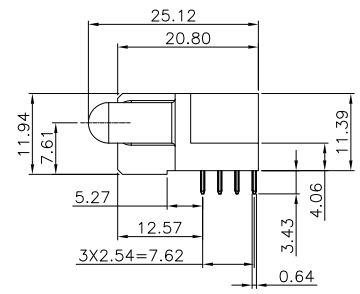
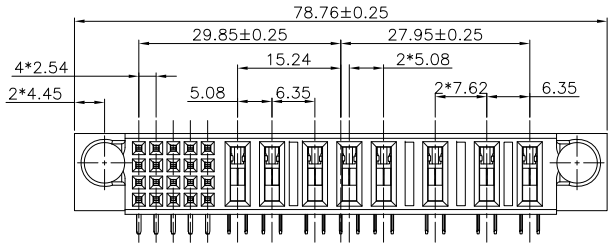

***RoHS Compliant**

Notes 1:
 H: High density Power---PCB Mount 5.08mm Pitch
 P: DC Power---PCB Mount 6.35mm Pitch
 A: AC Power---PCB Mount 7.62mm Pitch
 S: Signal---PCB Mount 2.54mm Pitch

Notes 2:
 P1, P2, P7, P8, Power Contact To The Top Distance is 2.34mm.
 P3, P4, P5, P6, Power Contact To The Top Distance is 1.07mm.

SIGNAL		POWER						ROWS						
5	4	3	2	1	P8	P7	P6	P5	P4	P3	P2	P1		
LLLLL					FM	FM	FS	FS	FS	FS	FM	FM		D
LLLLL														C
LLLLL														B
LLLLL														A

POWER CONTACT TO THE TOP DISTANCE 2.34mm, THE MATING LENGTH 3.61mm	FM
POWER CONTACT TO THE TOP DISTANCE 1.07mm, THE MATING LENGTH 4.89mm	FS
SIGNAL CONTACT 3.43 SOLDER TAIL, PD/NI	L

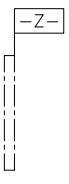
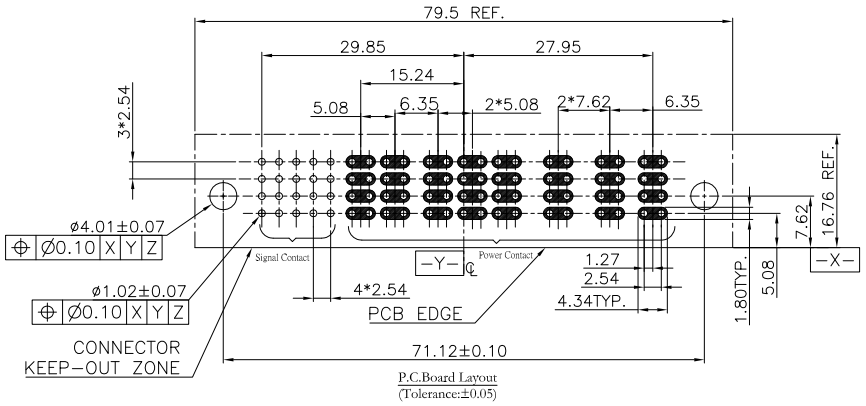

9391-A 4 S20 H2 P H3 A A1 A P2 CB 30 D A -A039

Series
 4: Female Right-angle
 Blank/Without Contact
 Signal Contact: Sxx
 No. of position
 Blank/Without Contact
 Power Contact: Hxx, Pxx, Ass
 No. of position
 Power of the Pitch adjacent(A or P or H)
 Blank/Without Contact
 Power Contact: Hxx, Pxx, Ass
 No. of position
 Power of the Pitch adjacent(A or P or H)
 Blank/Without Contact
 Power Contact: Hxx, Pxx, Ass
 No. of position
 Power of the Pitch adjacent(A or P or H)

Internal Code
 A: Tray Package
 D: Dip Type
 -05: 05u"
 30: 30u"
 C: Selective Gold Plated
 CB: Dip Tin Plated Contact Au+Pd/Ni Plated
 Blank/Without Contact
 Power Contact: Hxx, Pxx, Ass
 No. of position

Tolerances	Dwg. No.	9391-D0000-341	Title:		9391 Series Female Right-angle Dip Type		 OUPIIN ELECTRONIC(KUNSHAN) CO., LTD. P/N: 9391-A4S20H2PH3AA1AP2CB30DA-A039			
x = ±0.5	Projection		Unit	mm	Scale	1:1			SHEET	1/1
.x = ±0.25	Drawn By	XS 10/13'23								
.xx = ±0.15										