

REV.	SPECIFICATION	ECN NO.	APPD.

**Material:**  
Housing: PBT, UL94V-0, Black.  
Contacts: Brass, Gold Plated over Nickel 30u".  
Shell: Steel.

**Electrical Characteristics:**  
Current Rating: 1 AMP.  
Dielectric Withstanding Voltage: AC 1000V.  
Insulator Resistance: 1000MΩ min.  
Contact Resistance: 30mΩ max.  
Operating Temperature: -20°C~+70°C.

**\*RoHS Compliant**

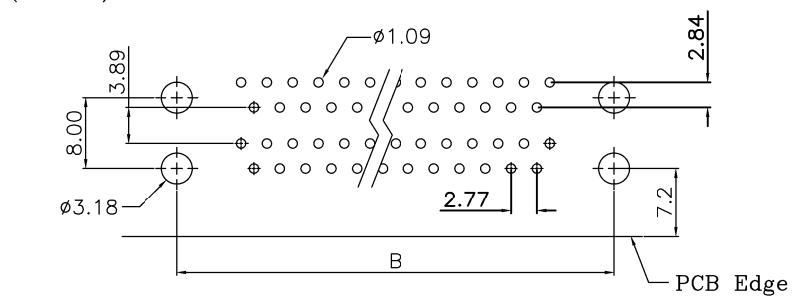
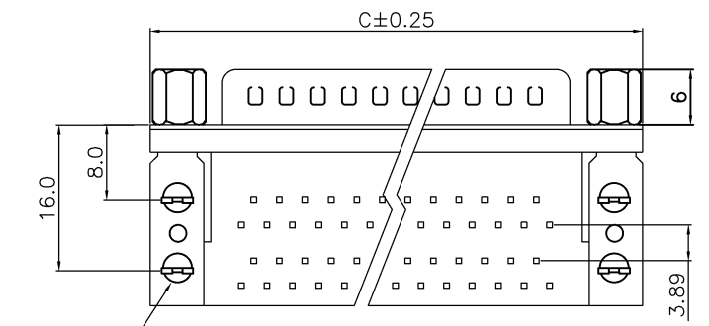
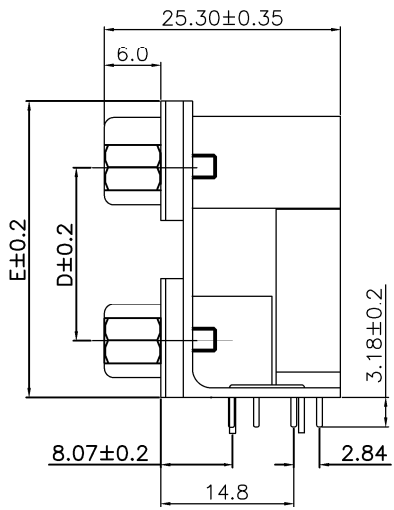
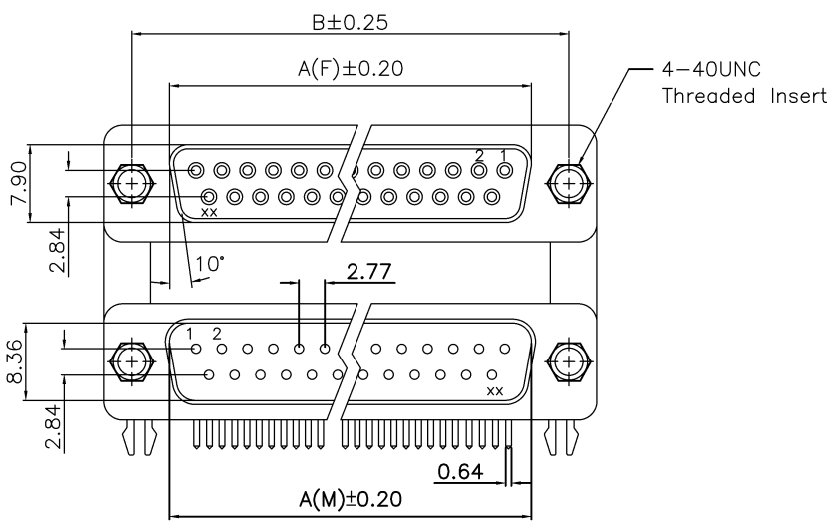

7936- xx F M Y x A- 6MM  
Series Position F: Female M: Male Y: Grounding Fork 1:15.88 See Dim:D A:Tray Package Hight of Jack Screw  
Top Bottom Jack Screw Attached 2:19.05 See Dim:D

Position	Dimension							
	A(M)	A(F)	B	C	D	E		
9	16.92	16.32	24.99	30.81	15.88	19.05	28.43	31.60
15	25.25	24.66	33.32	39.14	15.88	19.05	28.43	31.60
25	38.96	38.38	47.04	53.04	15.88	19.05	28.43	31.60

Tolerances	Dwg. No.	7936D03030	
x = ±0.50	Projection	⊕ ⊖	
.x = ±0.25	Unit	mm	Scale 1:1
.xx = ±0.15	Drawn By	Martin 09/29/22	

Title:  
7936 Series  
D-SUB Double Port  
Right Angle Type  
⊕512

<b>OUPIIN</b>			
OUPIIN ELECTRONIC(KUNSHAN) CO., LTD.			
P/N: 7936-xxFMYxA-6MM			
SHEET	1/1	Ver.No.	A2