

REV.	SPECIFICATION	ECN NO.	APPD.
R1			

Material:

Housing: 30% Glass Filled PBT UL94V-0.

Contacts: Phosphor Bronze.

Electrical Characteristics:

Current Rating: 2 AMP.

Dielectric Withstanding Voltage: AC 1000V For 1 minute.

Insulator Resistance: 1000MΩ min. at DC 500V.

Contact Resistance: 20mΩ max. at DC 100mA.

Operating Temperature: -55°C ~ +105°C .

***RoHS Compliant**

Insertion Depth: 3.40mm to 6.90mm.

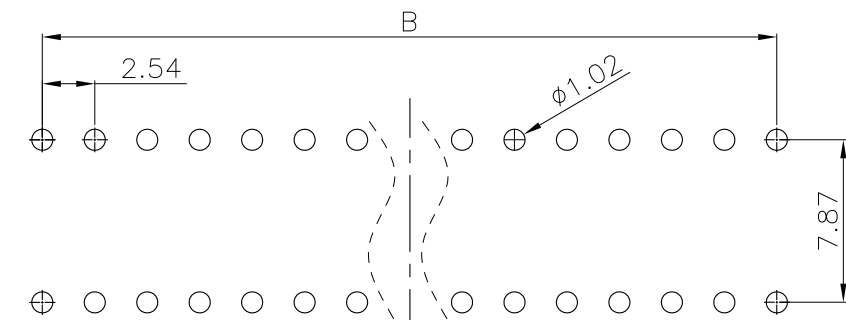
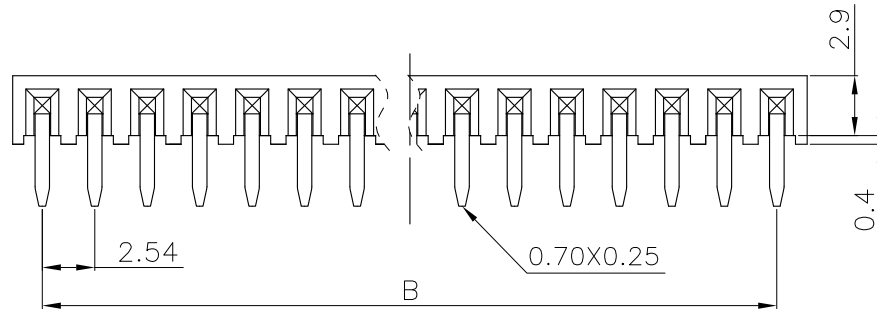
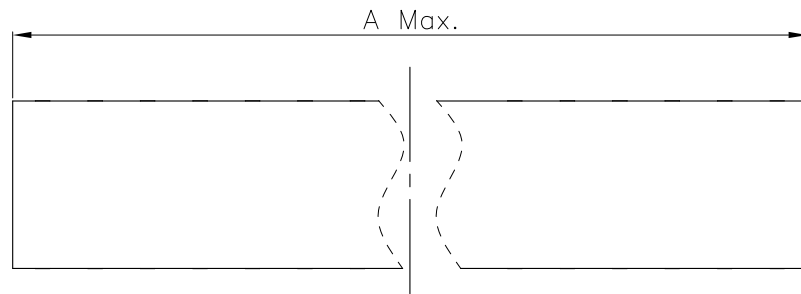
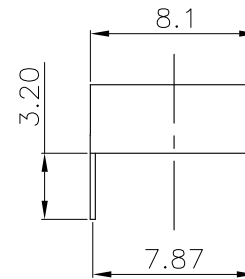
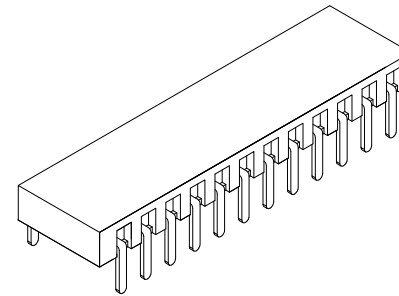

P.C. Board Layout
(Tolerance: ±0.05)

2049- 1 X xx G xx U
 Series — 1 — X — xx — G — xx — U
 Single Row —
 No. of Pin Per Row —
 U: Tube Package
 00: G/F
 10: 10 μ"
 15: 15 μ"
 30: 30 μ"
 G: Gold Plated
 T: Tin Plated

Position	2 Thru 40
Dimension	
A	2.54 X No. of Positions
B	2.54 X No. of Positions -2.54

Tolerances	Drawn No.	2049-D0000-001	Title:	2049 Series		
x = ±0.5	Projection		P.C.B. Socket 2.54mm(0.100")			
.x = ±0.25	Unit	mm			Scale	1:1
.xx = ±0.15	Drawn By	FHY02/16'09				

OUPIIN			
OUPIIN ELECTRONIC(KUNSHAN) CO., LTD.			
P/N: 2049-1XxxGxxU			
SHEET	1/1	Ver. No.	R1