

REV.	SPECIFICATION	ECN NO.	APPD.
R3		ECN210649	

Material:

Cage: Cu-Ni Alloy.

Electrical Characteristics:

Operating Temperature: -55°C~+105°C.

***RoHS Compliant**

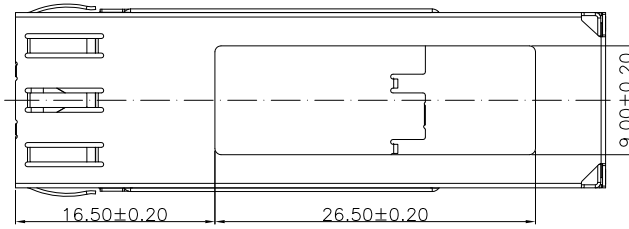

Heatsink Opening

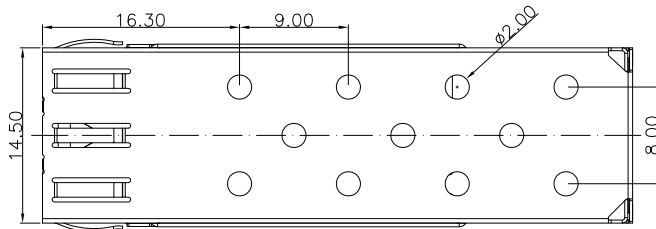

EMI Holes

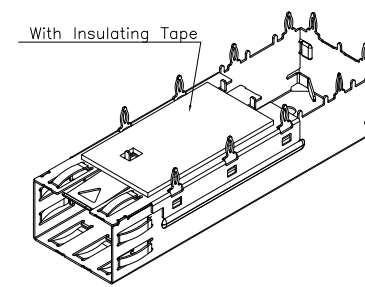
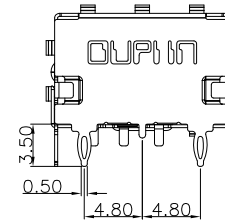
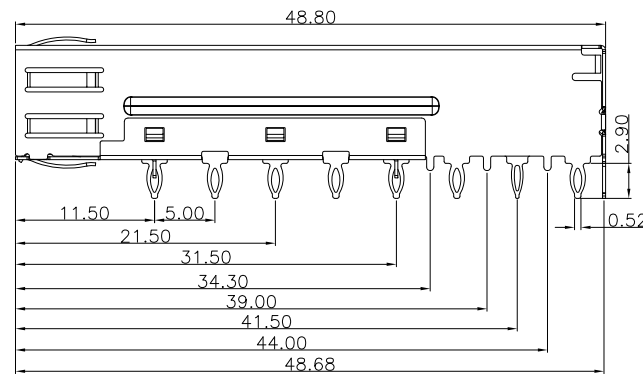
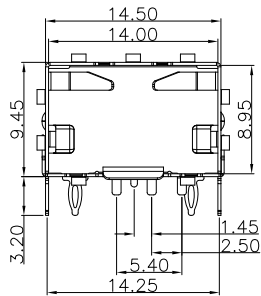

With Insulating Tape

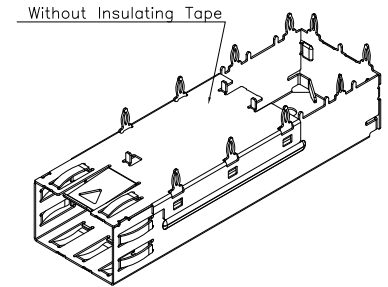

Without Insulating Tape

- 8951- 1 P S 0 x A
- Series | 1 | P | S | 0 | x | A
 - Ports |
 - P: Press Fit Type |
 - S: Spring |
 - 0: Without Light Pipe
 - 1: With Light Pipe
 - A: Tray Package
 - 0: Heatsink Opening, Without Insulating Tape
 - 1: EMI Holes, Without Insulating Tape
 - 2: Heatsink Opening, With Insulating Tape
 - 3: EMI Holes, With Insulating Tape

Tolerances	Dwg No.	8951-D0000-013		Title:
x = ±0.5	Projection	⊕ ⊖		8951 Series
.x = ±0.25	Unit	mm	Scale	1:1
.xx = ±0.15	Drawn By	WP 06/28'21		SFP Cage

OUPIN			
OUPIN ELECTRONIC(KUNSHAN) CO., LTD.			
P/N: 8951-1PS0xA			
SHEET	1/3	Ver.No.	R3

Notes:

1. Datum and basic dimensions established by customer.
2. Pads and vias are chassis ground, 11 places.
3. Thru holes, plating optional

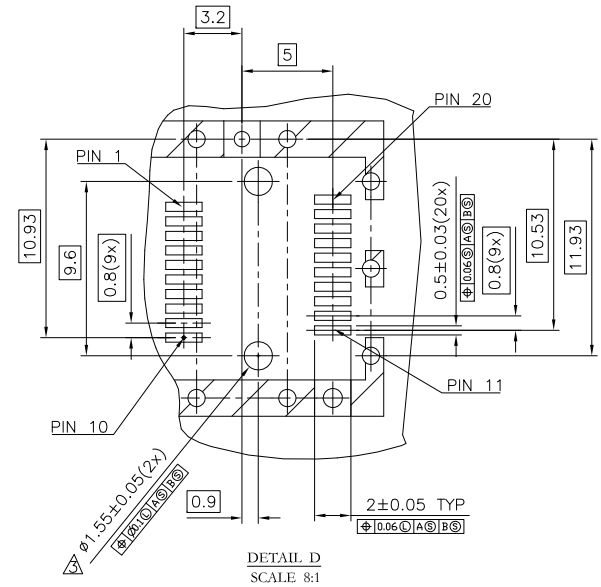
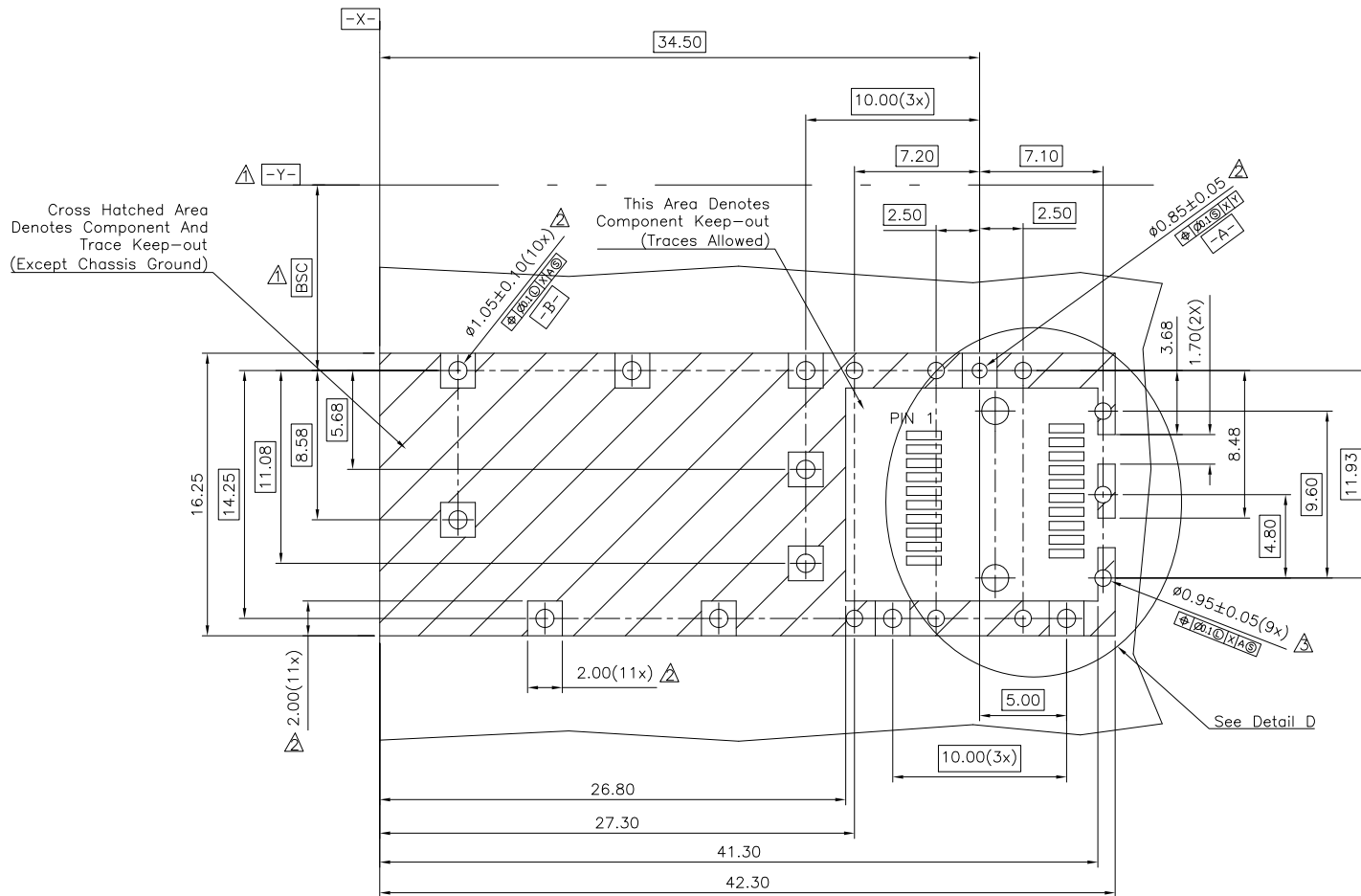

P.C. Board Layout
(Tolerance:±0.05)

Tolerances	Dwg No.	8951-D0000-013		Title:
x = ±0.5	Projection			8951 Series
.x = ±0.25	Unit	mm	Scale	1:1
.xx = ±0.15	Drawn By	WP 06/28'21		SFP Cage

Title:			
8951 Series			
SFP Cage			

OUPIN			
OUPIN ELECTRONIC(KUNSHAN) CO., LTD.			
P/N: 8951-1PS0xA			
SHEET	2/3	Ver.No.	R3

REV.	SPECIFICATION	ECN NO.	APPD.
R3		ECN210649	

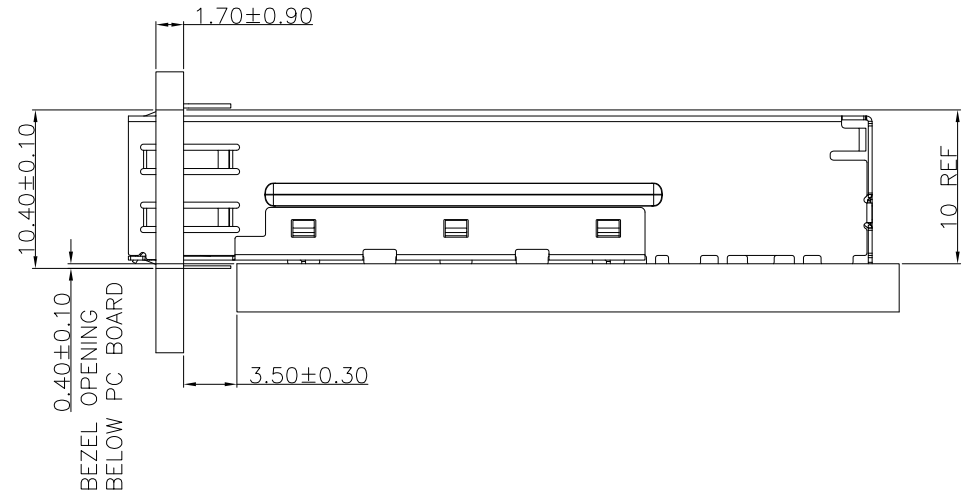
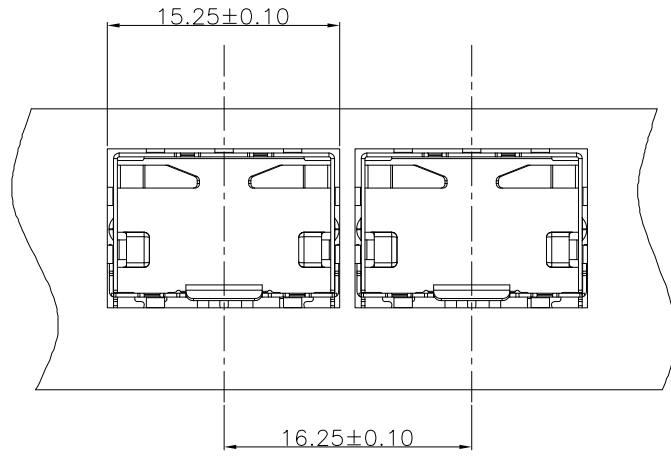

Tolerances x = ±0.5 .x = ±0.25 .xx = ±0.15	Dwg No.	8951-D0000-013		Title: 8951 Series SFP Cage	 OUPIIN ELECTRONIC(KUNSHAN) CO., LTD.				
	Projection								P/N: 8951-1PS0xA
	Unit	mm	Scale		1:1	SHEET	3/3	Ver.No.	R3
	Drawn By	WP 06/28'21							