

REV.	SPECIFICATION	ECN NO.	APPD.
R3		ECN220534	

Material and Plating:

Housing: LCP, UL94V-0, Black.

Power Contacts: High Conductivity Copper.
30u"Au+Pd/Ni on Contact Area and 80u" Min Tin Plated on Press Fit over 50u" Min Nickel.

Signal Contacts : Brass

30u"Au+Pd/Ni on Contact Area and 80u" Min Tin Plated on Press Fit over 50u" Min Nickel.

Electrical Characteristics:

Current Rating: Signal Pin: 2.5 A.

Power Pin: 65 A(2oz x 6).

Dielectric Withstanding Voltage:

Signal Pin DC 1000V For 1 minute.

Power Pin DC 2500V For 1 minute.

Insulator Resistance: Signal Pin 500MΩ max.

Power Pin 1000MΩ max.

Contact Resistance: Signal Pin 20mΩ max. at DC 20 mA.

Power Pin 0.7mΩ max. at DC 20 mA.

Operating Temperature: -40°C ~+125°C .

***RoHS Compliant**

Notes 1 :

H: High density Power---PCB Mount 5.08mm Pitch

P: DC Power---PCB Mount 6.35mm Pitch

A: AC Power---PCB Mount 7.62mm Pitch

S: Signal---PCB Mount 2.54mm Pitch

Notes 2 :

a5,b5,c5,d5 Contact Length is 5.59mm.

Other Pin Contact Length is 6.86mm.

ROWS	SIGNAL					POWER				
	1	2	3	4	5	P1	P2	P3	P4	P5
D	G	G	G	G	G	MS	MS	MS	MS	MS
C	G	G	G	G	G	MS	MS	MS	MS	MS
B	G	G	G	G	G	MS	MS	MS	MS	MS
A	G	G	G	G	G	MS	MS	MS	MS	MS

SIGNAL PIN CONTACT LENGTH 4.32mm	H
SIGNAL PIN CONTACT LENGTH 5.59mm	E
SIGNAL PIN CONTACT LENGTH 7.05mm	F
SIGNAL PIN CONTACT LENGTH 6.86mm	G
HOT PLUG POWER CONTACT.STD	MS

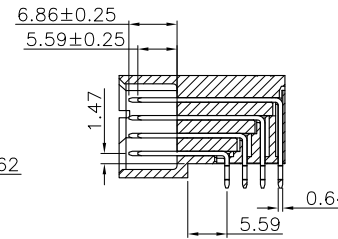
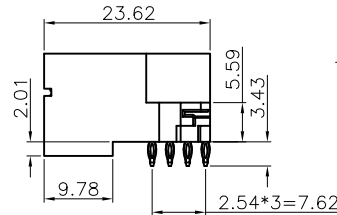
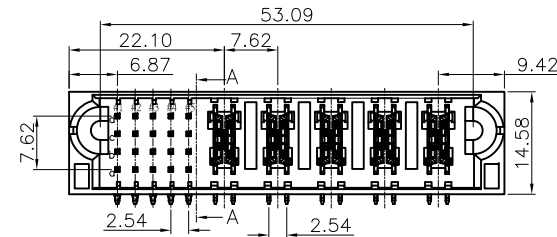
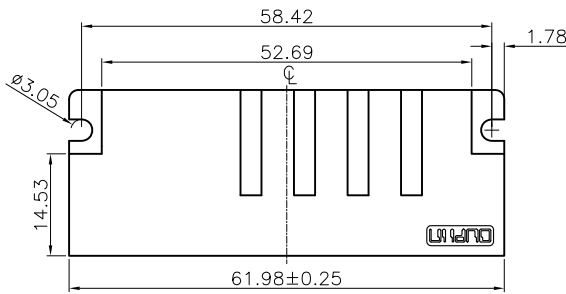
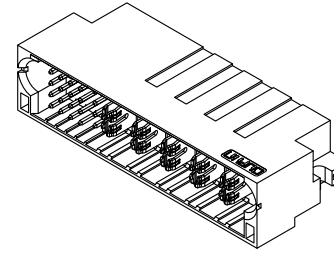

Section: A-A

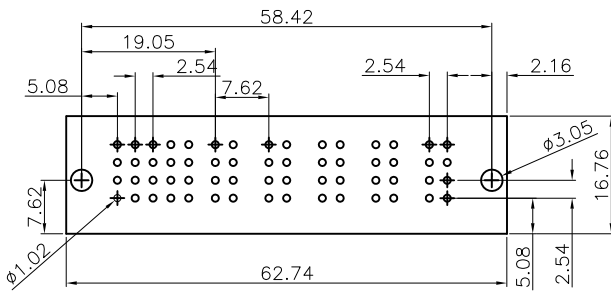

P.C.Board Layout
(Tolerance:±0.05)

9303- 1 S20 A05 CB 30 P A - A004 Internal Code
 Series
 1:Male Right-angle
 Blank: Without Contact
 Signal Contact: S xx
 No. of position
 Blank:Without Contact
 Power Contact: Hxx, Pxx , Axx
 No. of position
 A:Tray Package
 P:Press Fit Type
 30: 30 u"
 CB: Contact Au+Pd/Ni,Dip Tin

Tolerances	Dwg. No.	9303-D0000-019		Title:	
x = ±0.5	Projection	⊕ ↗		9303 Series Male Right-angle	
.x = ±0.25	Unit	mm	Scale		1:1
.xx = ±0.15	Drawn By	XS 05/15'22			

OUPIN			
OUPIN ELECTRONIC(KUNSHAN) CO., LTD.			
P/N: 9303-1S20A05CB30PA-A004			
SHEET	1/1	Ver. No.	R3