

REV.	SPECIFICATION	ECN NO.	APPD.
R6		ECN121230	

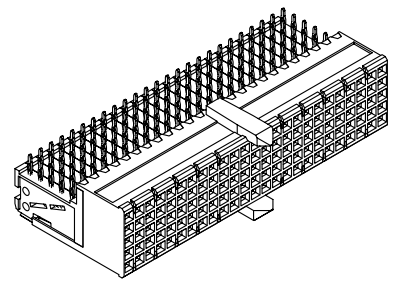
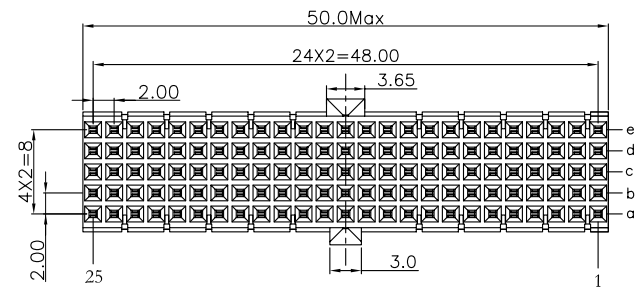

Material:

Housing: Thermoplastic Polyester Glass Filled UL94V-0.
 Contacts: Copper Alloy.

Electrical Characteristics:

Current Rating: 1 AMP.
 Dielectric Withstanding Voltage: AC 750V For 1 minute.
 Insulator Resistance: 10000MΩ min. at DC 500V.
 Contact Resistance: 20mΩ max. at DC 100mA.
 Operating Temperature: -55°C ~ +125°C .

***RoHS Compliant**

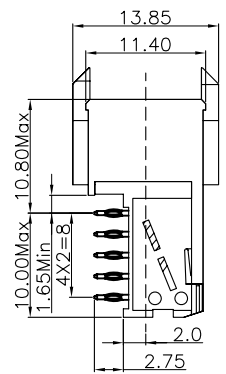
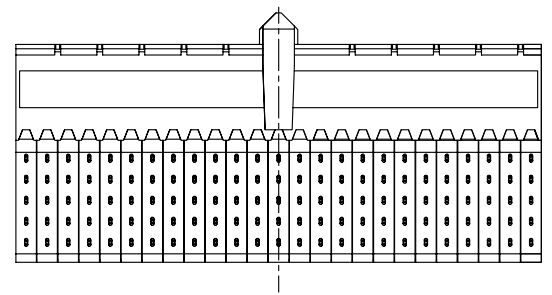

None Shielded

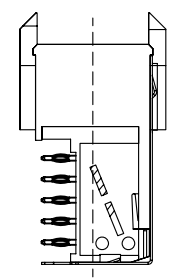

With Top Body Shielded

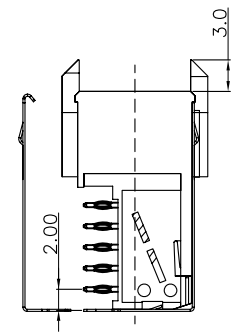

With Top Body Shielded and Bottom Shielded

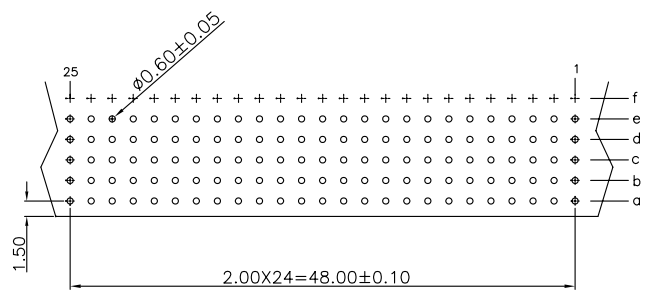

P.C. Board Layout
(Top View)

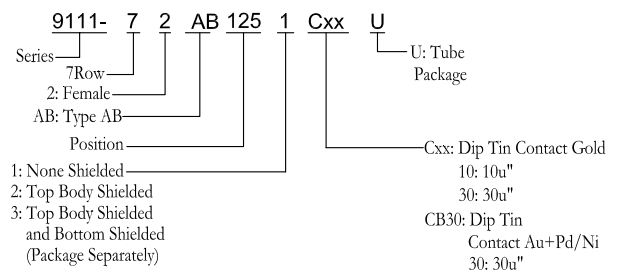

Tolerances x = ±0.5 .x = ±0.25 .xx = ±0.15	Dwg. No.	9111D72010		Title: 9111 Series Hard Metric Connector Female Right Angle Type AB-25	 OUPIIN ELECTRONIC(KUNSHAN) CO., LTD.				
	Projection								P/N: 9111-72AB125xCxxU
	Unit	mm	Scale		1:1	SHEET	1/1	Ver.No.	R6
	Drawn By	CQ 12/14'12							