

TOP LAYER DESCRIPTION	TABLE 1 PLATED THROUGH-HOLE REQUIREMENTS								FINISHED HOLE DIAMETER (DIM"A")
	DRILLED HOLE DIAMETER	COPPER THICKNESS	TIN-LEAD THICKNESS	NICKEL THICKNESS	GOLD THICKNESS	TIN THICKNESS	SILVER THICKNESS	COPPER THICKNESS	
TIN-LEAD	0.81-0.88(0.85 DRILL)	0.025-0.050	0.005-0.015						0.65-0.80
IMMERSION TIN	0.81-0.88(0.85 DRILL)	0.025-0.050				0.9-1.5um			0.70-0.80
IMMERSION SILVER	0.81-0.88(0.85 DRILL)	0.025-0.050					0.15-0.65um		0.70-0.80
COPPER	0.81-0.88(0.85 DRILL)	0.025-0.050						0.003 MAX	0.70-0.80
GOLD	0.81-0.88(0.85 DRILL)	0.025-0.050		0.003-0.007	FLASH UP TO 0.0002				0.69-0.80

REV.	SPECIFICATION	ECN NO.	APPD.
R2		ECN181040	

Material and Plating:

Housing: LCP,UL94V-0 , BLACK.
 Power Contacts: High Conductivity Copper.
 Au+Pd/Ni or Gold Plated on Contact Area and 80u" Min
 Tin Plated on Press Fit over Nickel 50u" Min .

Electrical Characteristics:

Current Rating: 20 AMP@75°C ambient.
 Dielectric Withstanding Voltage: AC 1500V For 1 minute.
 Insulator Resistance: 10000MΩ min. at DC 500V.
 Contact Resistance: 1.0mΩ max.
 Operating Temperature: -55°C~+105°C.

***RoHS Compliant**

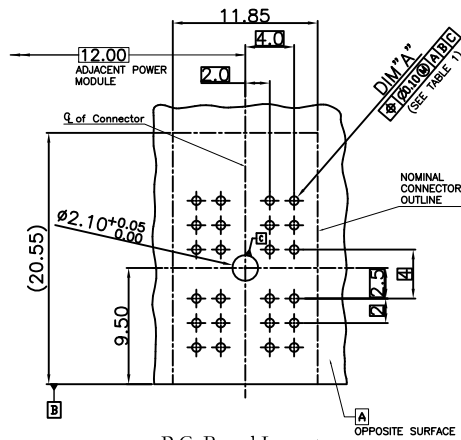
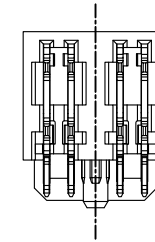
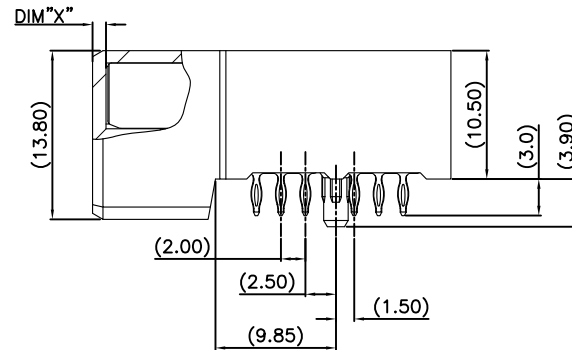
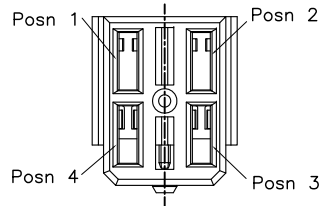
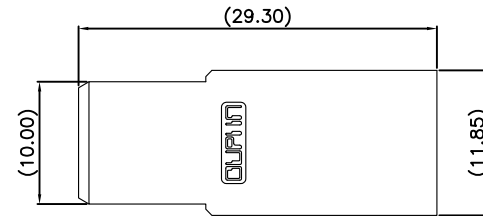
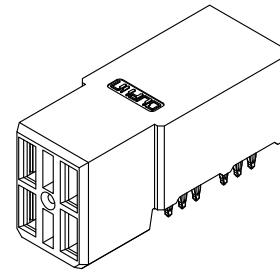

P.C. Board Layout
(Tolerance:±0.05)

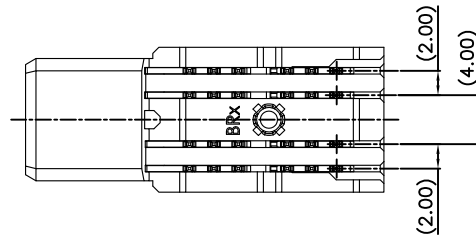

Series 9114 - 2 x 2 Cxx P P x R A
 Position Per Column
 Column No.
 Cxx: Selective Gold Plated
 00: 00μ"
 10: 10μ"
 15: 15μ"
 30: 30μ"
 CB30:Dip Tin
 Contact Au+Pd/Ni
 30: 30μ"
 A: Tray Packaging
 R: Right Angle type
 1~7 Type
 P: With Post
 N: Without Post
 Press fit Type

Product No.	**Available Product			
	DIM 'X'			
	Posn 1	Posn 2	Posn 3	Posn 4
9114-2X2CxxPx1RA	1.10	1.10	1.10	1.10
9114-2X2CxxPx2RA	2.60	2.60	2.60	2.60
9114-2X2CxxPx3RA	1.10	2.60	2.60	2.60
9114-2X2CxxPx4RA	2.60	1.10	2.60	2.60
9114-2X2CxxPx5RA	2.60	2.60	1.10	2.60
9114-2X2CxxPx6RA	2.60	2.60	2.60	1.10
9114-2X2CxxPx7RA	1.10	2.60	2.60	1.10

Tolerances	Dwg. No.	9114-D0000-019	Title:
x = ±0.5	Projection		9114 Series
.x = ±0.25	Unit mm	Scale	2.00mm Pitch Power Conn.
.xx = ±0.15	Drawn By	WP 10/31'18	

OUPIN			
OUPIN ELECTRONIC(KUNSHAN) CO., LTD.			
P/N: 9114-2x2CxxPPxRA			
SHEET	1/1	Ver.No.	R2