

|      |               |           |       |
|------|---------------|-----------|-------|
| REV. | SPECIFICATION | ECN NO.   | APPD. |
| R1   |               | ECN191037 |       |

**Material and Plating:**  
**Housing:** LCP, UL94V-0, Black.  
**Power Contacts:** High Conductivity Copper.  
 30u"Au+Pd/Ni on Contact Area and 80u" Min Tin Plated on Solder Tail over 50u" Min Nickel.  
**Signal Contact:** Phosphor Bronze.  
 30u"Au+Pd/Ni on Contact Area and 80u" Min Tin Plated on Solder Tail over 50u" Min Nickel.

**Electrical Characteristics:**  
**Current Rating:** Signal Pin 2.5 AMP.  
 Power Pin 30 AMP.  
**Dielectric Withstanding Voltage:**  
 Signal Pin DC 1000V For 1 minute.  
 Power Pin DC 2500V For 1 minute.  
**Insulator Resistance:** Signal Pin 5000MΩ min. at DC 500V.  
 Power Pin 20000MΩ min. at DC 500V.  
**Contact Resistance:** Signal Pin 15mΩ max. at DC 20mA.  
 Power Pin 0.7mΩ max. at DC 20mA.  
**Operating Temperature:** -40°C ~+105°C .

**\*RoHS Compliant**  
**Notes 1 :**  
 H: High density Power---PCB Mount 5.08mm Pitch  
 P: DC Power---PCB Mount 6.35mm Pitch  
 A: AC Power---PCB Mount 7.62mm Pitch  
 S: Signal---PCB Mount 2.54mm Pitch  
**Notes 2 :**  
 P6、P8 Without Power Contact.  
 P2 Power Contact to the Top Distance is 2.34mm.  
 P1, P3, P4, P5, P7 Power Contact to the Top Distance is 1.07mm.

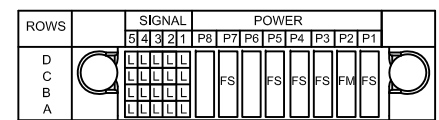

|  |    |
|--|----|
| POWER CONTACT TO THE TOP DISTANCE 2.34mm, THE MATING LENGTH 4.06mm | FM |
| POWER CONTACT TO THE TOP DISTANCE 1.07mm, THE MATING LENGTH 5.33mm | FS |
| SIGNAL CONTACT 3.43 SOLDER TAIL, PD/Ni                             | L  |

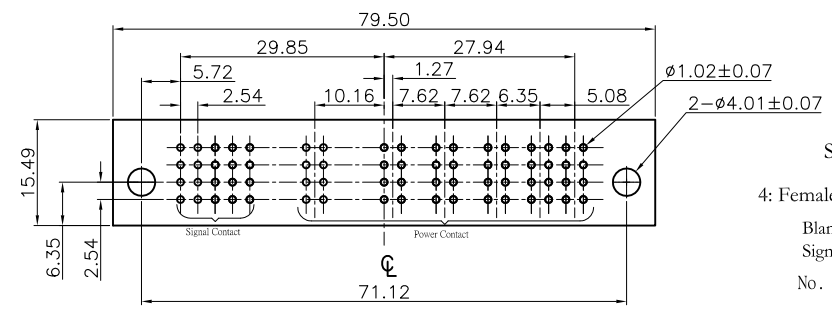
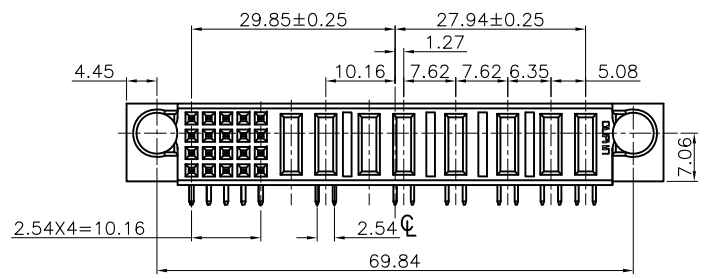
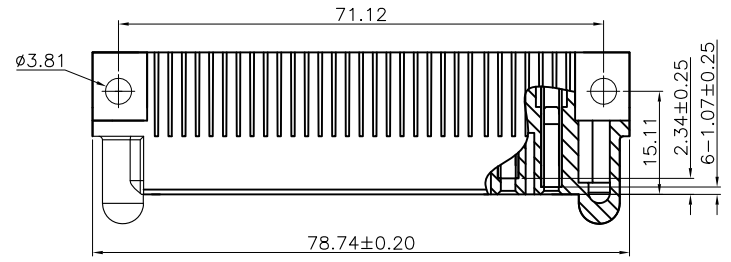
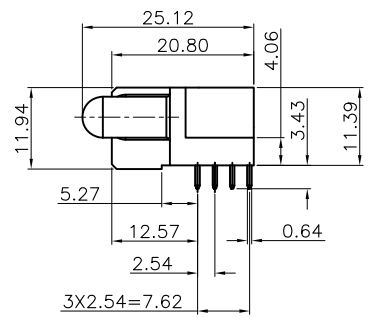
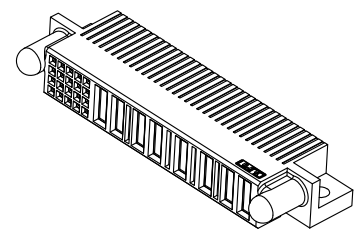

P.C.Board Layout  
(Tolerance:±0.05)

Series **9391-A** 4 **S20** **H08** **CB** **30** **D** **A** - **A032** Internal Code  
 4: Female Right-angle  
 Blank: Without Contact  
 Signal Contact: S<sub>xx</sub>  
 No. of position  
 H08: H1HP1PA3HH1PP1HH1  
 A: Tray Package  
 D: Dip Type  
 30: 30 u"  
 CB: Contact Au+Pd/Ni Plated Dip Tin Plated

|             |            |                 |                             |     |
|-------------|------------|-----------------|-----------------------------|-----|
| Tolerances  | Dwg. No.   | 9391-D0000-268  | Title:                      |     |
| x = ±0.5    | Projection |                 | 9391 Series                 |     |
| .x = ±0.25  | Unit       | mm              | Scale                       | 1:1 |
| .xx = ±0.15 | Drawn By   | bo-min 12/04'19 | Female Right-angle Dip Type |     |

|                                     |     |          |    |
|-------------------------------------|-----|----------|----|
| <b>OUPIN</b>                        |     |          |    |
| OUPIN ELECTRONIC(KUNSHAN) CO., LTD. |     |          |    |
| P/N: 9391-A4S20H08CB30DA-A032       |     |          |    |
| SHEET                               | 1/1 | Ver. No. | R1 |