

REV.	SPECIFICATION	ECN NO.	APPD.
R6		ECN170528	

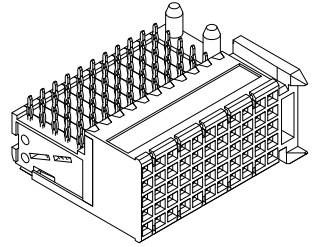
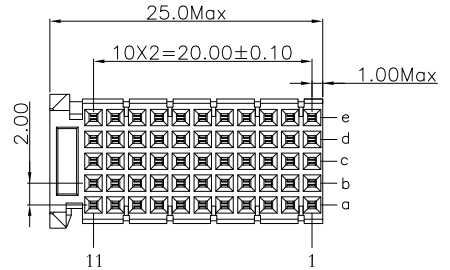

**Material:**  
**Housing:** Thermoplastic Polyester Glass Filled UL94V-0.  
**Contacts:** Copper Alloy

**Electrical Characteristics:**  
**Current Rating:** 1 AMP.  
**Dielectric Withstanding Voltage:** AC 750V For 1 minute.  
**Insulator Resistance:** 10000MΩ min. at DC 500V.  
**Contact Resistance:** 20mΩ max. at DC 100mA.  
**Operating Temperature:** -55°C ~+125°C .

**\*RoHS Compliant**

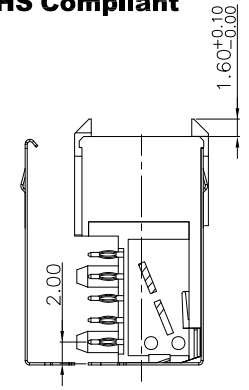
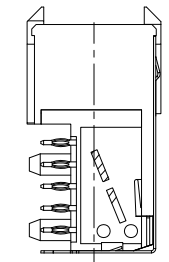
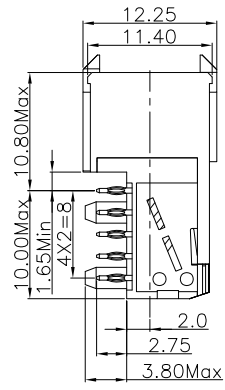
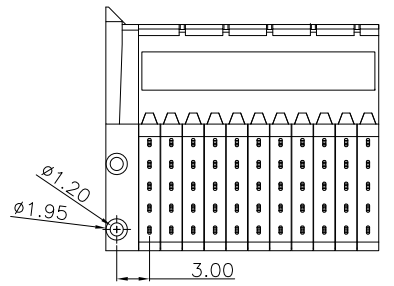

None Shielded

With Top Body Shielded

With Top Body Shielded and Bottom Shielded

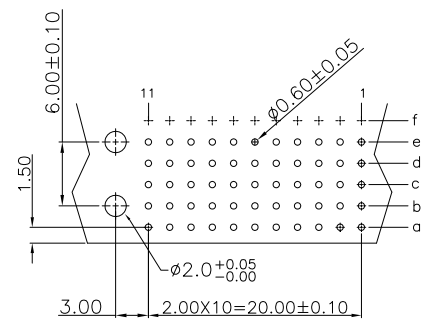

P.C. Board Layout  
(Top View)

**9111- 7 2 C 55 x Cxx U**

Series: 9111-  
 7: 7 Row  
 2: 2: Female  
 C: Type C  
 Position: 55  
 Cxx: Dip Tin Contact Gold  
 U: Tube Package

1: None Shielded  
 2: Top Body Shielded  
 3: Top Body Shielded and Bottom Shielded (Package Separately)

10: 10u"  
 30: 30u"  
 CB30: Dip Tin Contact Au+Pd/Ni  
 30: 30u"

Tolerances	Dwg. No.	9111D72005	
x = ±0.5	Projection	⊕ ↗	
.x = ±0.25	Unit	mm	Scale 1:1
.xx = ±0.15	Drawn By	LQ 05/17'17	

Title: 9111 Series  
 Hard Metric Connector  
 Female Right Angle Type C

<b>OUPIN</b>			
OUPIN ELECTRONIC(KUNSHAN) CO., LTD.			
P/N: 9111-72C55xCxxU			
SHEET	1/1	Ver.No.	R6