

REV.	SPECIFICATION	ECN NO.	APPD.

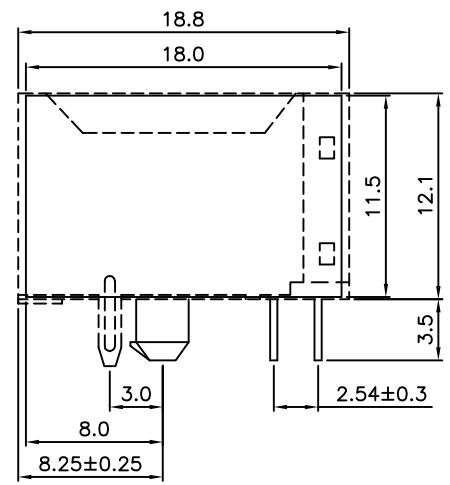
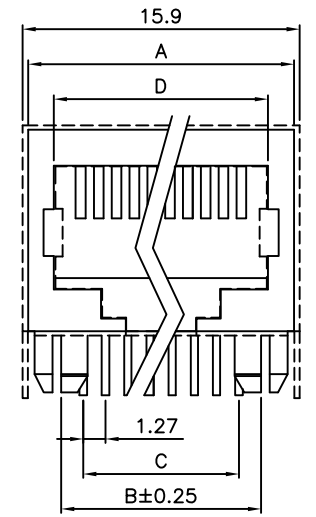

Material:

Housing: PBT, UL94V-0, Black.
 Contacts: Phosphor Bronze, Gold Plated on Contact Area and 120 u" Min Tin Plated on Solder Tail over Nickel 35 u" Min.
 Shield: Brass, Nickel Plated.

Electrical Characteristics:

Voltage Rating: 125V.
 Current Rating: 1.5 AMP.
 Dielectric Withstanding Voltage: AC 1000V.
 Insulation Resistance: 1000MΩ min. at DC 500V.
 Contact Resistance: 30mΩ max. at DC 100mA.
 Operating Temperature: -40°C~+85°C.

Mechanical Characteristics:

Insertion Force: 1.4 Kgf Max.
 Withdrawal Force: 7.5 Kgf Min.
 Durability: 750 Cycles.
***RoHS Compliant**

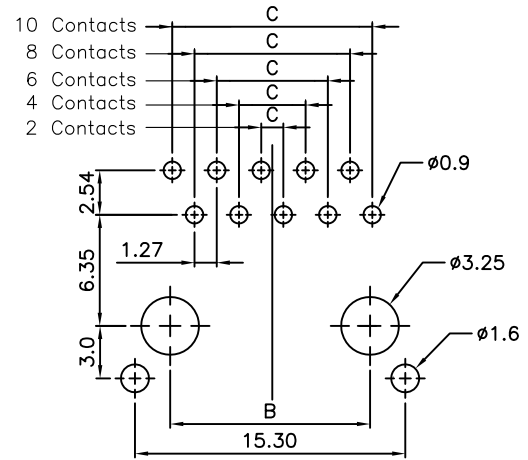

- 8949-K1 10 10 -06 S B A
- Series
 - 10: 10 Position Housing
 - 8: 8 Position Housing
 - 6: 6 Position Housing
 - 4: 4 Position Housing
 - 10: 10 Contacts Loaded
 - 8: 8 Contacts Loaded
 - 6: 6 Contacts Loaded
 - 4: 4 Contacts Loaded
 - 2: 2 Contacts Loaded
 - A: Tray Package
 - B: Black
 - S: Shield
 - (Only for 8 & 10 Position)
 - Blank: Non-Shield
 - 06: 06 μ" Gold Plated
 - 15: 15 μ" Gold Plated
 - 30: 30 μ" Gold Plated
 - 50: 50 μ" Gold Plated

No. of Position	No. of Contacts	Dimensions			
		A	B	C	D
4	4	11.2	7.62	3.81	7.8
6	2	13.2	10.16	1.27	10.0
6	4	13.2	10.16	3.81	10.0
6	6	13.2	10.16	6.35	10.0
8	8	15.2	11.43	8.89	12.0
10	10	15.2	11.43	11.43	12.0

Tolerances	Dwg No.	8949D02010		Title:	
.x = ±0.50	Projection	⊕ ◀		8949-K1 Series Modular Jack	
.xx = ±0.25	Unit	mm	Scale		1:1
.xxx = ±0.15	Drawn By	jia-chi 11/08'17			

OUPIN
 OUPIIN ELECTRONIC(KUNSHAN) CO., LTD.
 P/N: 8949-K1xx-06SBA
 SHEET 1/1 Ver.No. A8

©773