

REV.	SPECIFICATION	ECN NO.	APPD.

Material:
Housing: PA6T, UL94V-0, Natural.
Contacts: Phosphor Bronze, 120~130u" Tin Plated over Nickel 50u".
Solder Pad: Phosphor Bronze, 120~130u" Tin Plated over Nickel 50u".

Electrical Characteristics:
Current Rating: 1 AMP.
Dielectric Withstanding Voltage: AC 500V.
Insulator Resistance: 100MΩ min.
Contact Resistance: 20mΩ max.
Operating Temperature: -25°C~+85°C.
***RoHS Compliant**

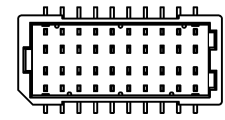
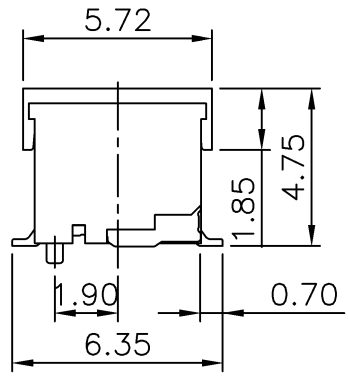
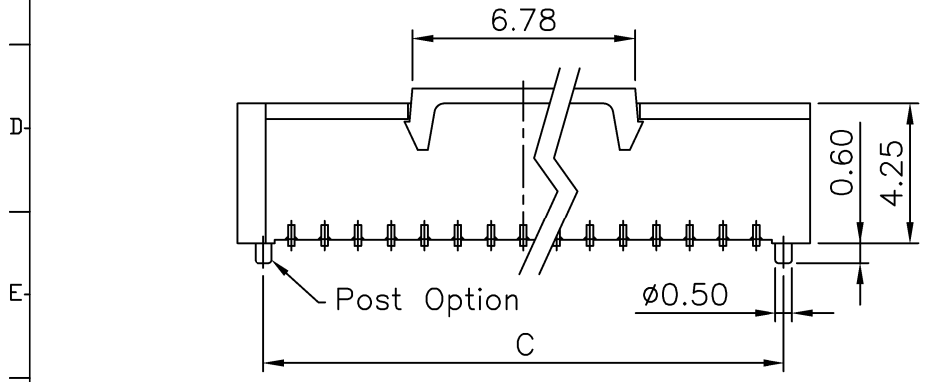
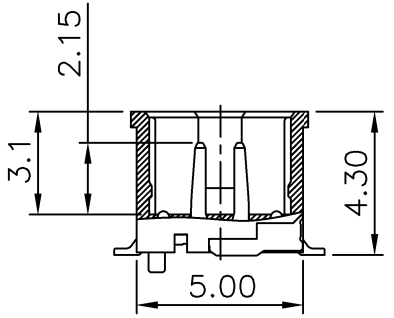
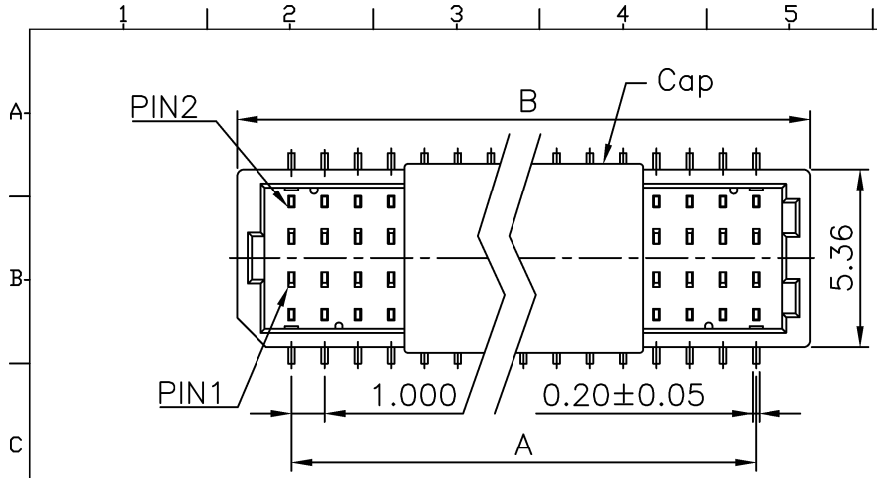

Without Cap

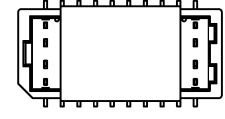

With Cap

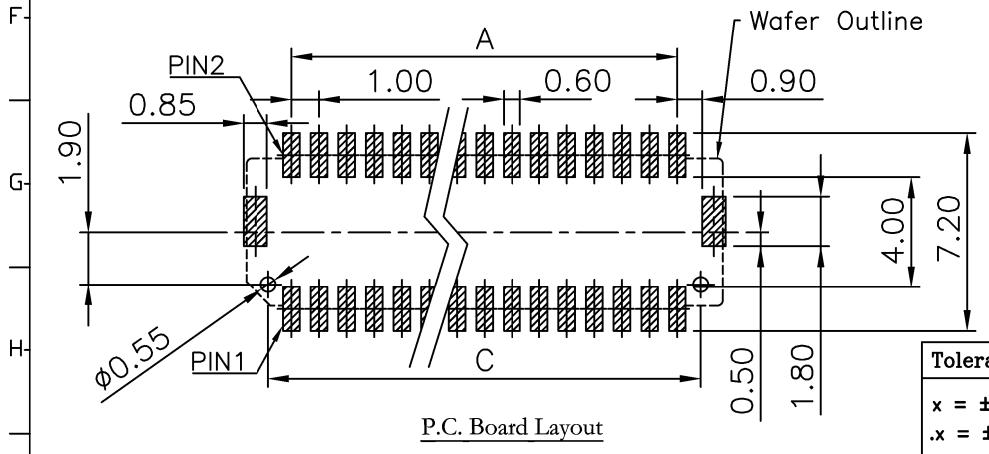

Series 4472- 2 X xx T D3 T -P
2: Double Row
No. of Position
T: Tin Plated
G00: Gold Flash
Blank: W/O Pad
P: Plastic Pad
U: Tube Package
T: Tape & Reel Package
D3: SMD Top Entry with Post
D3N: SMD Top Entry W/O Post

Position	Dimension		
	A	B	C
2x10	9.00	12.30	10.70
2x15	14.00	17.30	15.70
2x20	19.00	22.30	20.70
2x25	24.00	27.30	25.70

Tolerances	Dwg. No.	4472D01005
x = ±0.5	Projection	
.x = ±0.35	Unit	mm
.xx = ±0.25	Scale	1:1
	Drawn By	Jerry 10/23'19

Title: 4472 Series
1.0mm wire to Board
Dual Row SMD Top Entry Type
704

OUPIN ELECTRONIC(KUNSHAN) CO., LTD.			
P/N: 4472-2XxxTD3T-P			
SHEET	1/1	Ver.No.	A4