

REV.	SPECIFICATION	ECN NO.	APPD.

**Material:**  
Housing: Thermoplastic Polyester UL94V-0.  
Solder Pin: Copper Alloy, Tin Plated.  
**Electrical Characteristics:**  
Voltage Rating: 300V.  
Current Rating: 6A.  
Solid Wire(AWG): 16~22.  
Stranded Wire(AWG): 16~22.  
Wire Strip Length: 8.5~10mm.  
Withstanding Voltage: 1.6KV.  
Operating Temperature: -40°C~+115°C  
**\*RoHS Compliant**

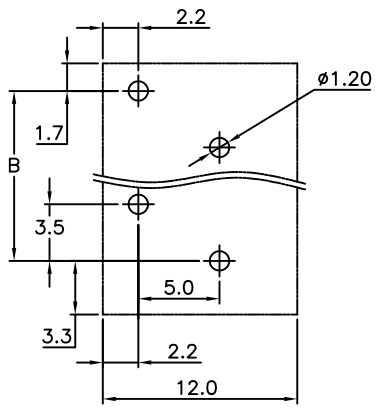
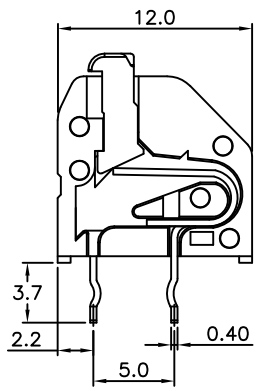
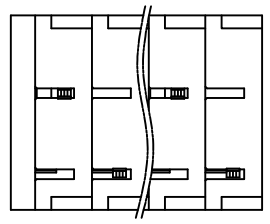
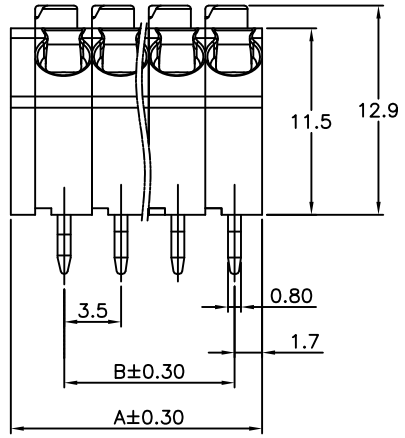
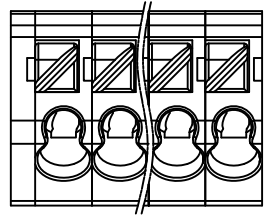

P.C. Board Layout

8935- C 120129 Y EA xx S B  
Series C:Pitch Manufacturing Y:Grey EA Type No. of S:Straight B:Box Package  
3.5mm Code B:Black G:Green

Position	2 Thre 24
Dimension	
A	No. of PositionsX3.5+1.5
B	(No. of Positions-1)X3.5

Tolerances	Dwg. No.	8935D02006
X= ±0.50	Projection	
.X= ±0.30	Unit	mm
.XX= ±0.15	Scale	1:1
	Drawn By	Vic Lyu01/08'15

Title:  
8935 Series  
3.5mm Terminal Block  
(8300-XXTS32-06)

**OUPIN**  
**OUPIN ELECTRONIC(KUNSHAN) CO., LTD.**  
P/N: 8935-C120129YEAxxSB  
SHEET 1/1 Ver.No. X2

780