

REV.	SPECIFICATION	ECN NO.	APPD.

Material:
Contacts: Brass.
Terminal Plating: 40~80u" Tin Plated over Nickel 10~20u" or Gold Flash on Contact Area over Nickel 20~30u".
Recommend Wire: 22 AWG To 30 AWG.
 Insulation OD: 1.60~1.13mm.
***RoHS Compliant**

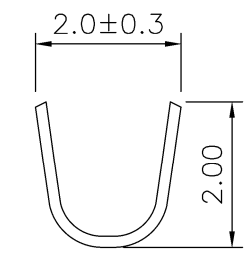

Section A-A'

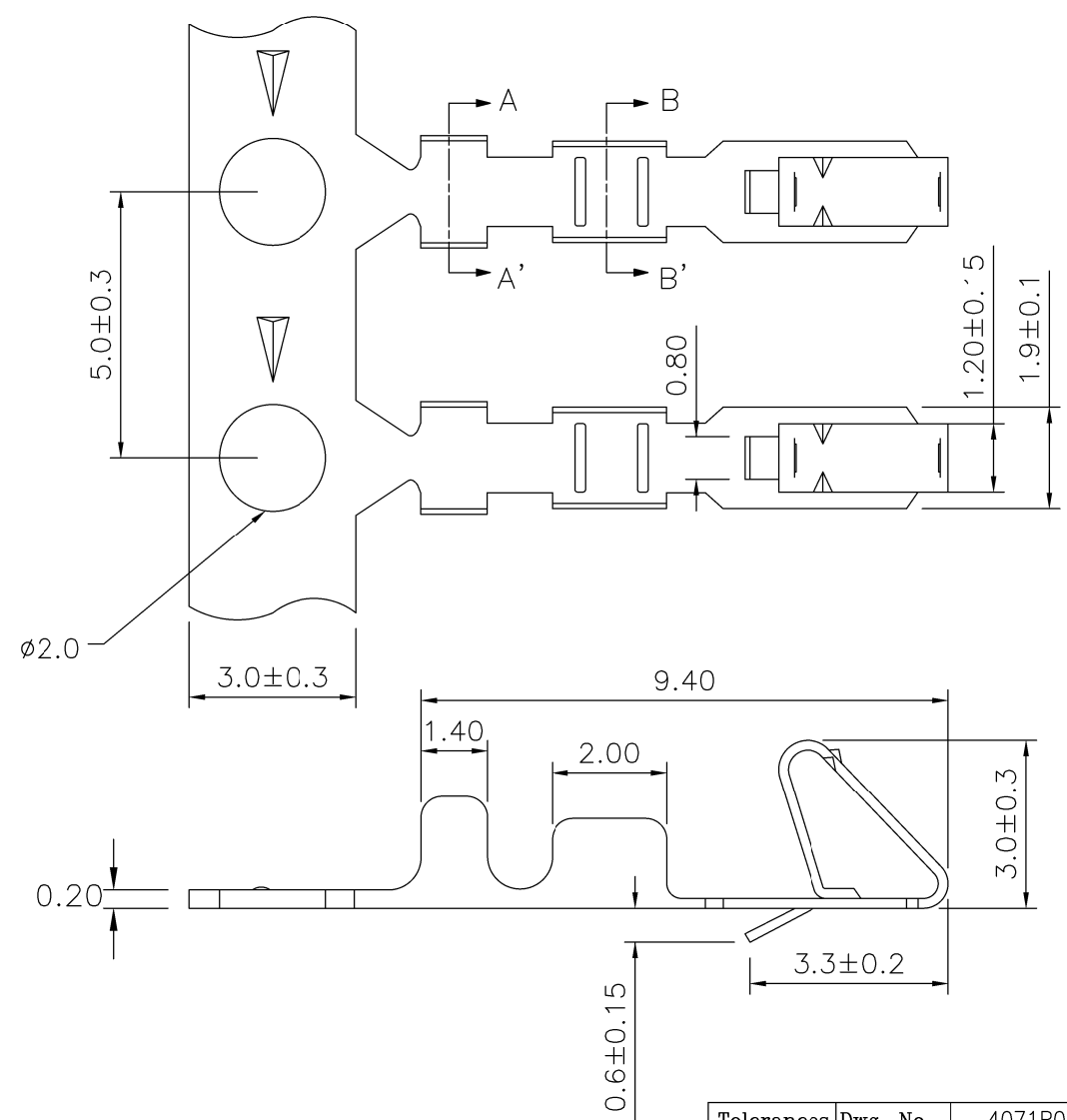
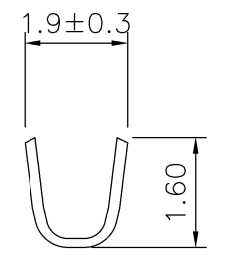

Section B-B'

4071- PIN -x -10K
 Series Pin T: Tin Plated C: Selective Gold Plated
 10K Pins Per Reel

Tolerances	Dwg. No.	4071P02001		Title:
.x = ±0.35	Projection	⊕ ↗		4071 Series
.xx = ±0.25	Unit	mm	Scale	1:N
.xxx = ±0.15	Drawn By	Martin	Date	09/12'22

Wire to Board Terminal 2.54mm
 704

OUPIIN			
OUPIIN ELECTRONIC(KUNSHAN) CO., LTD.			
P/N: 4071-PIN-T-10K			
SHEET	1/1	Ver.No.	A6