

REV.	SPECIFICATION	ECN NO.	APPD.
R2		ECN200847	

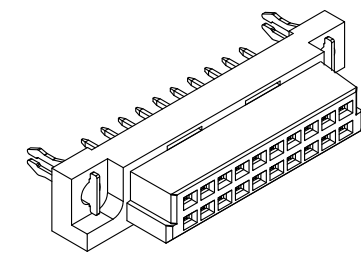
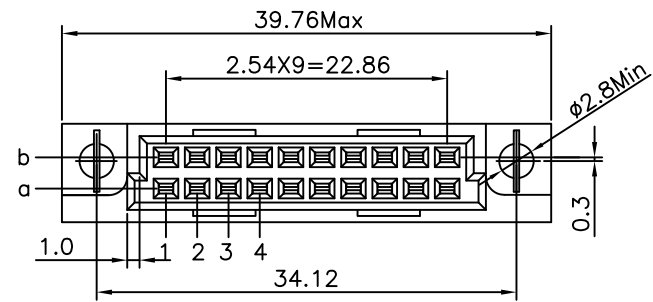

**Material and Plating:**

Housing: PBT, UL94V-0,Beige.  
 Contacts: Copper Alloy.  
 Lock: Phosphor Bronze.  
 Gold Plated on contact Area and 80u"Min Tin or Gold Flash plated on solder tail over 50u"Min Nickel.

**Electrical Characteristics:**

Current Rating: 2 AMP.  
 Dielectric Withstanding Voltage: AC 1000V For 1 minute.  
 Insulator Resistance: 1000MΩ min. at DC 500V.  
 Contact Resistance: 20mΩ max. at DC 100mA.  
 Operating Temperature: -55°C~+125°C .

**\*RoHS Compliant**

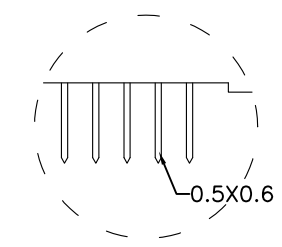
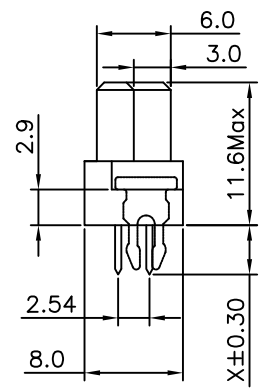
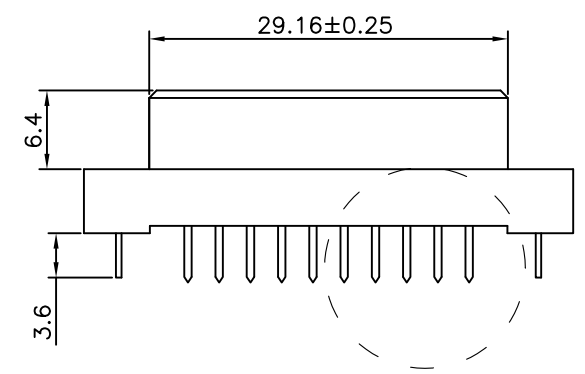

Dip :1,2

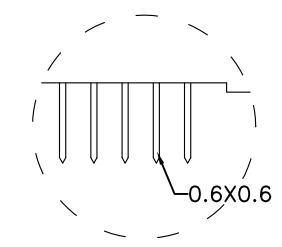

Dip :W1,W2

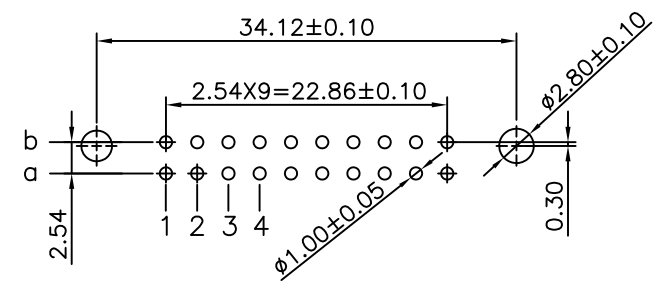

P.C. Board Layout  
(Tolerance:±0.05)

9001- 3 6 xx x C xx L1 A  
 Series  
 3: 2.54mm  
 6: Female  
 Position  
 1: Dip Length  
 2: Dip Length  
 W1: Dip Length  
 W2: Dip Length  
 C: Dip Tin  
 Contact Gold  
 G: Gold Plated  
 A: Tray Package  
 Blank: Without Lock  
 L1: With Lock  
 00: G/F  
 10: 10u"  
 15: 15u"  
 30: 30u"

Pitch	Position	Rows with Contacts	Contact Arrange	X length	1	2	W1	W2
					4.0	2.5	13	17
2.54mm	20	a b	b a 1 2 3 4	P/N				
	10	a -	b a 1 2 3 4	9001-3620xCxxL1A 9001-3610xCxxL1A				

Tolerances	Dwg. No.	9001D36012	
x = ±0.5	Projection	⊕ ◁	
.x = ±0.25	Unit	mm	Scale 1:1
.xx = ±0.15	Drawn By	SH 09/02'20	

Title: 9001 Series  
 DIN41612  
 Half B Type Female

**OUPIN**  
 OUPIN ELECTRONIC(KUNSHAN) CO., LTD.  
 P/N: 9001-36xxxCxxL1A  
 SHEET 1/1 Ver.No. R2