

REV.	SPECIFICATION	ECN NO.	APPD.

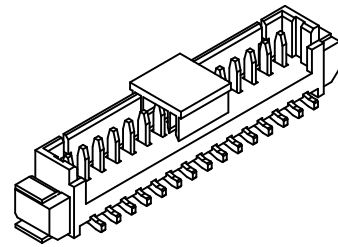
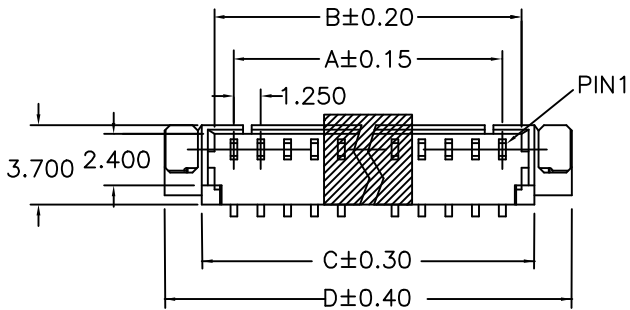

Material:

Housing: PA6T, UL94V-0, Natural.
 Contacts: Phosphor Bronze, 100u" Matte Tin Plated over Nickel 50u".
 Solder Pad: Brass, 100u" Matte Tin Plated over Nickel 50u".

Electrical Characteristics:

Current Rating: 1 AMP.
 Voltage Rating: AC 125V.
 Dielectric Withstanding Voltage: AC 250V.
 Insulator Resistance: 100MΩ min.
 Contact Resistance: 20mΩ max.
 Operating Temperature: -40°C~+85°C.

***RoHS Compliant**

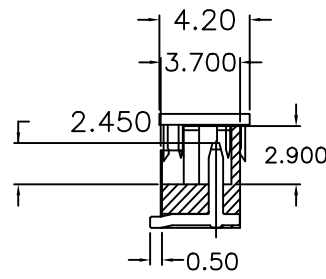
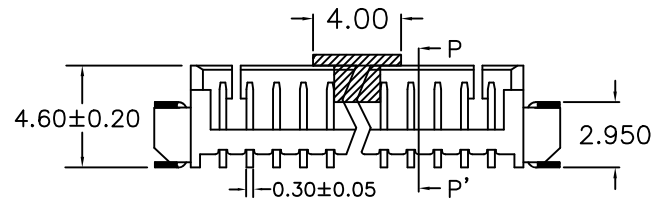

Top Entry
Section P-P'

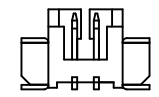

02~03P

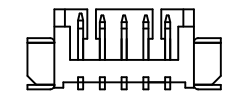

04~15P

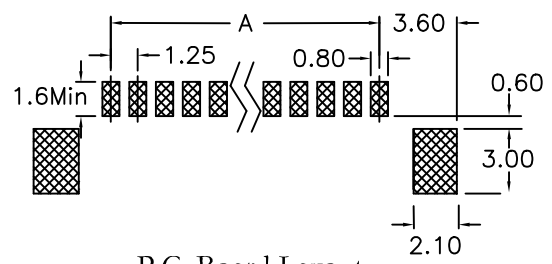

P.C. Board Layout

4573- xx MT D3 T -P
 Series No. of Pin Count MT: Matte Tin Plated D3: SMD Top Entry (Straight) T: Tube Package U: Tape & Reel Package Blank: W/O Pad P: Plastic Pad

Position	2 Thru 15
Dimension	
A	(No. of Positions X 1.25)-1.25
B	(No. of Positions X 1.25)+0.55
C	(No. of Positions X 1.25)+1.75
D	(No. of Positions X 1.25)+5.15

Tolerances	Dwg No.	4573D01003		
.x = ±0.35	Projection	⊕ ⊖		
.xx = ±0.25	Unit	mm	Scale	1:1
.xxx = ±0.15	Drawn By	Jerry 10/31'19		

Title: 4573 Series
 1.25mm wire to Board
 SMD Top Entry Type
 0704

OUPIIN
 OUPIIN ELECTRONIC(KUNSHAN) CO., LTD.
 P/N: 4573-xxMTD3T-P
 SHEET 1/1 Ver.No. A6